

# KASAI 更換新發電結構

## Kasai Dynacoil FS Dynamo Core

### Replacement Instructions

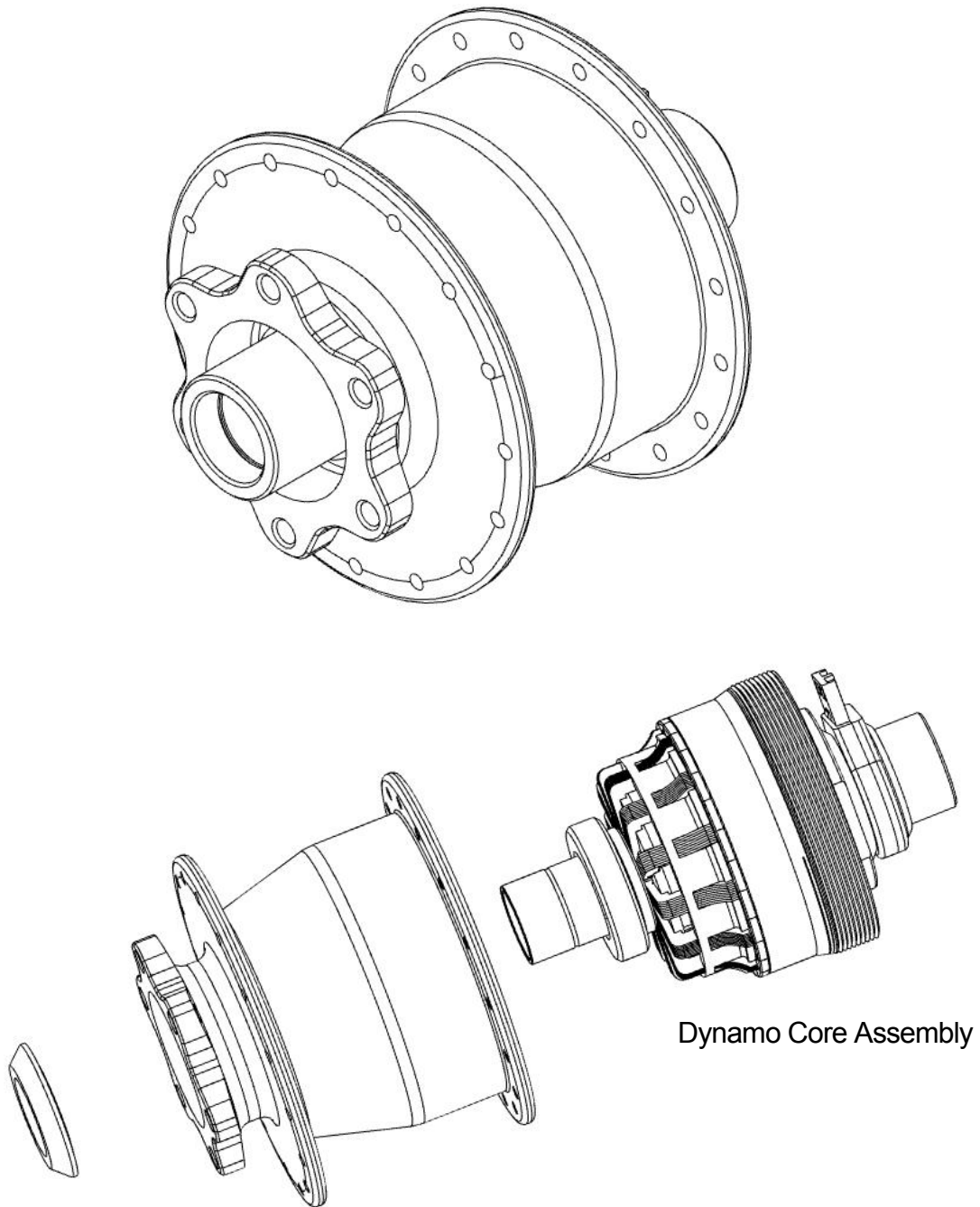

**KASAI**

拆卸與安裝方式說明  
Introduction of Removal & Installation

1. 取下兩邊側蓋

Remove end-cap on both sides

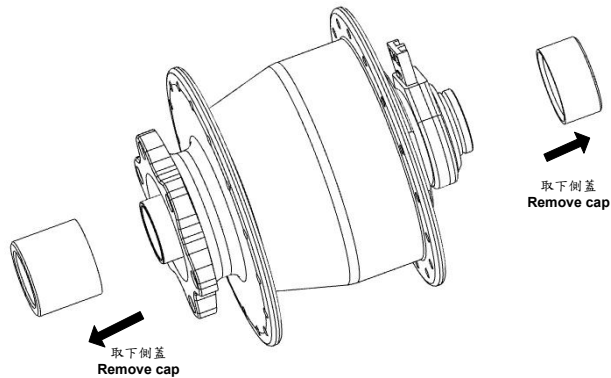

2. 36mm 板手旋開發電結構本體至空轉

Unscrew dynamo hub with 36mm wrench

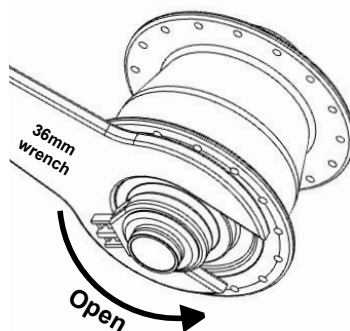

3. 用  $\varnothing 17\text{mm}$  圓棒頂住碟煞邊軸心，敲擊軸心後取出發電結構

Tap the axle out with a  $\varnothing 17\text{mm}$  rod, gently knock the axle and remove the dynamo core.

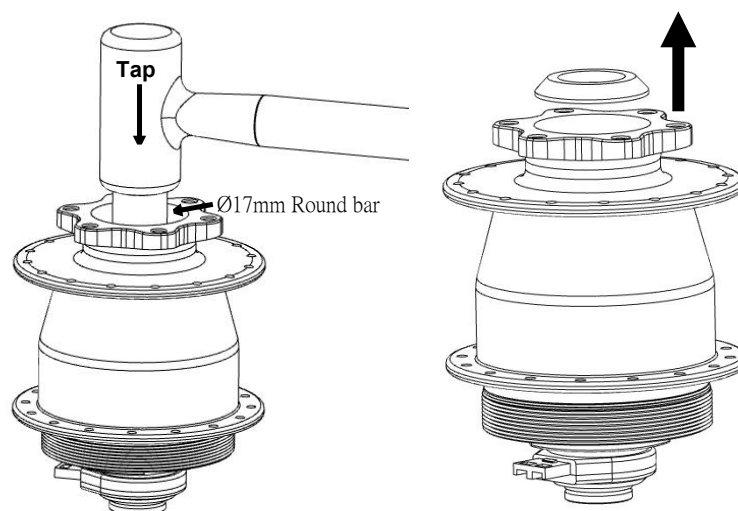

4. 卸出碟煞邊內部軸承

Unload the bearing at the disc side

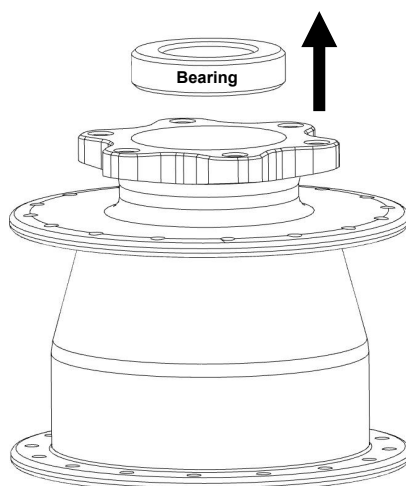

5. 清潔花鼓殼內部

Clean the inside of the hub shell

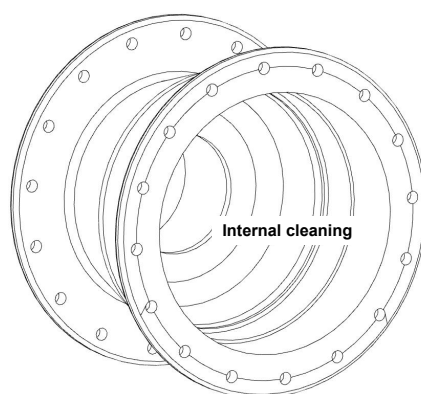

6. 安裝新軸承

Load with new bearing at the disc side.

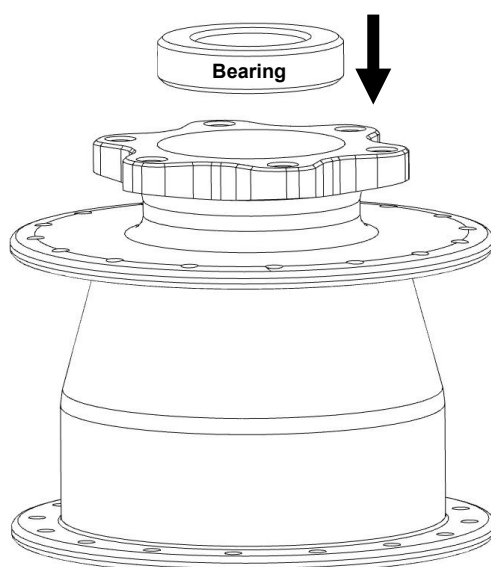

7. 36mm 板手旋入安裝新發電結構本體

Install the fresh dynamo core with 36mm wrench into the shell. If installing old shell, clean the threads of any debris. Apply some machine oil or WD-40 to threads to facilitate installation.

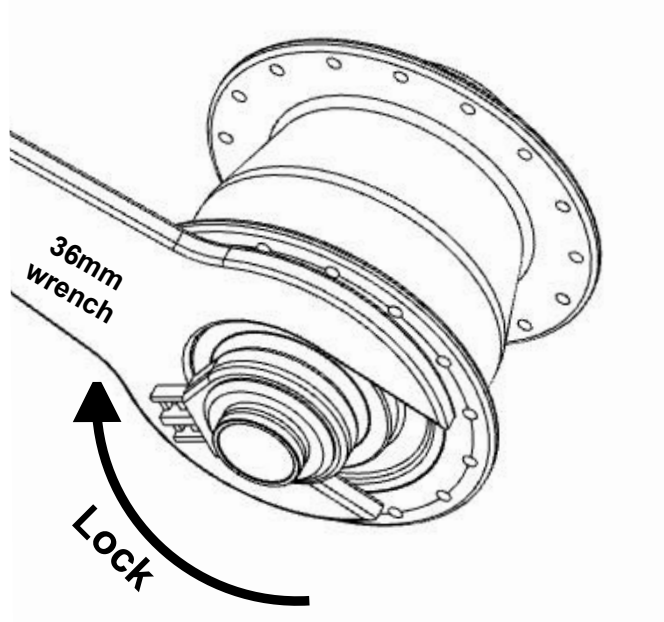

8. 安裝碟煞邊檔塊

Install the block at disc side

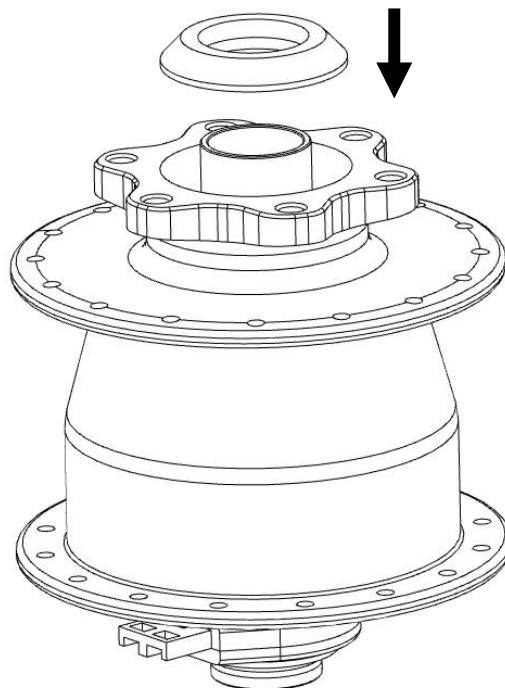

9. 安裝 O 形環  
Install the seal (O-ring)

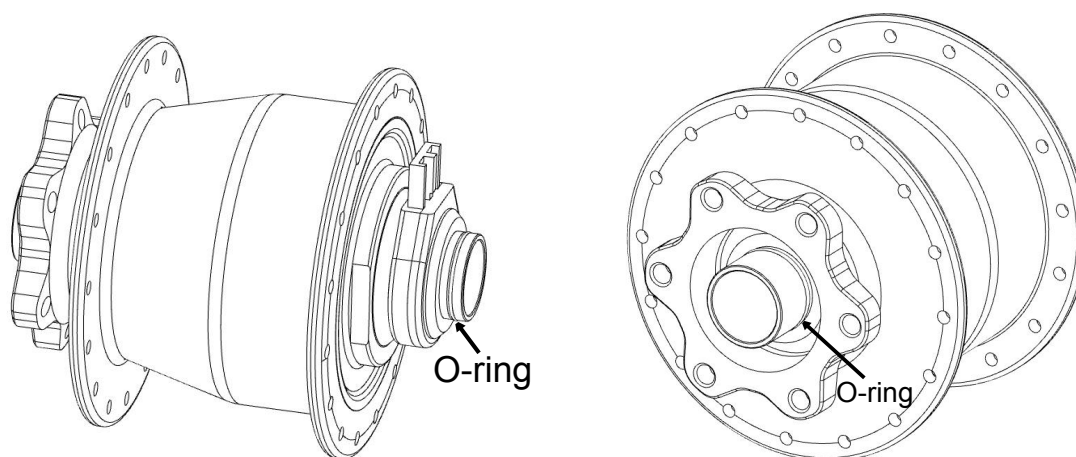

10. 安裝兩邊側蓋  
Press-fit end-cap at both side

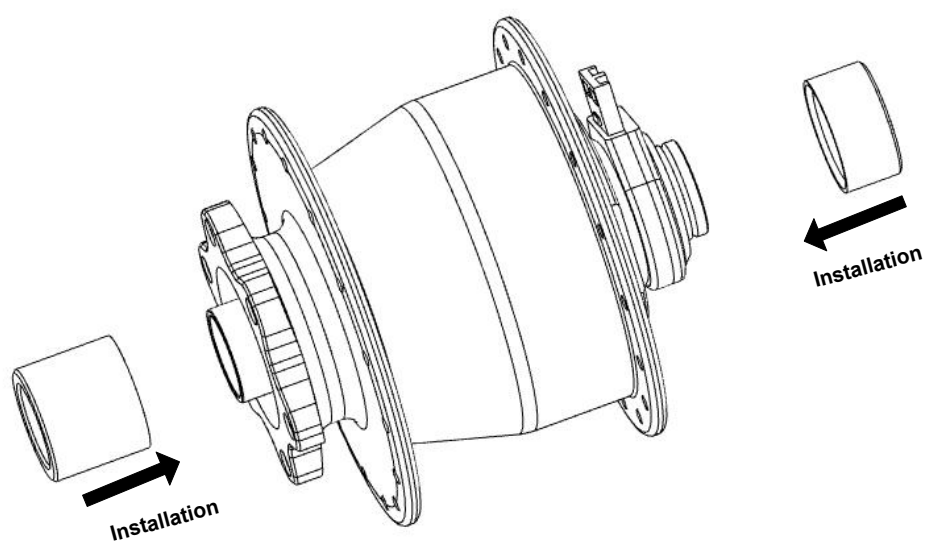



警告注意事項 CAUTION:

1. 發電輪鼓內部軸承無法 100%防水，不建議使用在超過輪鼓的水線道路(如:水位高過輪鼓河道)

The internal bearings of the Dynamo hub CAN NOT be 100% waterproof, so it is not recommended to use on waterway roads that exceed the Dynamo hub (for example, the water level above the Dynamo hub).

2. 軸承損壞或發電輪鼓已無電力能力才可拆卸更換。

Only if the bearing is damaged or the Dynamo hub has no power should you remove and replace the parts.

3. 安裝和鎖定過程中可在螺牙上塗抹潤滑油脂，方便旋入鎖緊。

During the installation and locking process, grease (WD-40) can be applied to the bolt teeth to facilitate screwing and locking.

4. 拆卸與安裝發電結構時必須注意連結器的的方向，避免造成安裝時損壞。

When disassembling and installing the dynamo structure, you must pay attention to the direction of the connector to avoid damage.